

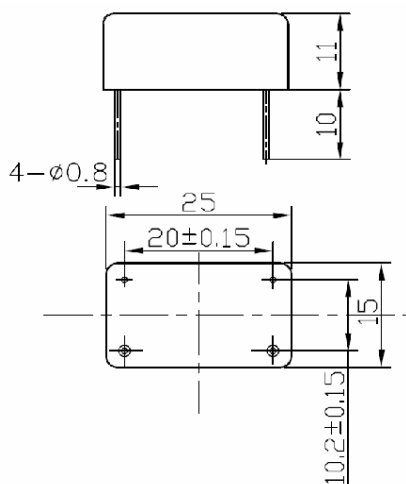

Specification: Crystal Filter 80MHz

P/N : 80M01B53

Item	Typical
Nominal Frequency (MHz)	80
Insertion Loss (dB)	12 max
Ripple within Pass Band (dB)	1.0
Pass Band at -1dB (kHz)	1.0
Bandwidth at 40dB Attenuation (kHz)	5.0
Ultimate Rejection (dB)	50
I/O Impedance (Ω)	50
I/O VSWR	≤ 1.8
Operation Temperature ($^{\circ}\text{C}$)	-40 ~ +85
Storage Temperature ($^{\circ}\text{C}$)	-45 ~ +95
Package Size (mm)	25x15x11



技术规范书 : 80MHz 晶体滤波器

型号 : 80M01B50



项目	典型值
中心频率 (MHz)	80
插入损耗 (dB)	12 max
带内波动 (dB)	1.0
-3dB 带宽 (kHz)	1.0
-40dB 带宽 (kHz)	5.0
最终衰减 (dB)	50
输入输出阻抗 (Ω)	50
工作温度范围 ($^{\circ}\text{C}$)	-20 ~ +70
存储温度范围 ($^{\circ}\text{C}$)	-45 ~ +85
外形封装尺寸 (mm)	30x20x12

